

**ASTORIA BUFFET**  
AST01BF673  
ASTORIA BÜFE

**RV02**

TOPLAM KUTU  
TOTAL BOXES  
COLLI ZAHL

**4**

| NO | KOD/CODE        | PARÇA ADI                    | NAME                               | ADET/PIECE | KUTU/BOX |
|----|-----------------|------------------------------|------------------------------------|------------|----------|
| 1  | 2AST001BF671821 | UST TABLA ARKA KAPAMA KAYITI | TOP PANEL - BACK BLANK FRAME       | 1          | 2        |
| 2  | 2AST001BF671801 | UST TABLA                    | TOP PANEL                          | 1          | 2        |
| 3  | 2AST001BF671812 | SABIT RAF UST                | FIXED SHELF TOP                    | 1          | 2        |
| 4  | 2AST001BF672813 | SABIT RAF ALT                | FIXED SHELF BOTTOM                 | 1          | 2        |
| 5  | 2AST001BF673902 | CATILMIS ALT TABLA           | MOUNTED BOTTOM PANEL               | 1          | 2        |
| 6  | 2AST001BF671803 | SAG YAN TABLA                | END PANEL - RIGHT                  | 1          | 3        |
| 7  | 2AST001BF673804 | SOL YAN TABLA                | END PANEL - LEFT                   | 1          | 3        |
| 8  | 2AST001BF671811 | SABIT RAF                    | FIXED SHELF                        | 4          | 3        |
| 9  | 2AST001BF671807 | ARA DIKME ALT UST            | MIDDLE VERTICAL PANEL - TOP BOTTOM | 2          | 3        |
| 10 | 2AST001BF671808 | ARA DIKME ORTA               | MIDDLE VERTICAL PANEL - MIDDLE     | 3          | 3        |
| 11 | 2AST001BF671861 | SAG KAPAK                    | RIGHT DOOR                         | 2          | 4        |
| 12 | 2AST001BF671862 | SOL KAPAK                    | LEFT DOOR                          | 2          | 4        |
| 13 | 2AST001BF671816 | ARKALIK BUVUK                | BACK PANEL - BIG                   | 2          | 4        |
| 14 | 2AST001BF671817 | ARKALIK KUCUK                | BACK PANEL - SMALL                 | 1          | 4        |
| 15 | 2AST001AKG73607 | AYAK                         | LEG                                | 4          | 1        |

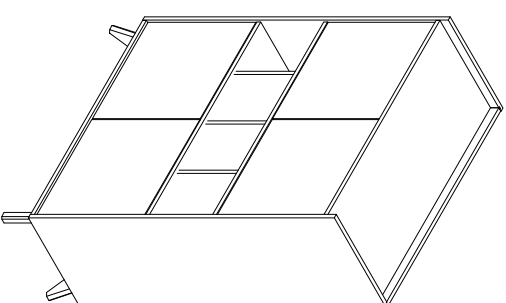
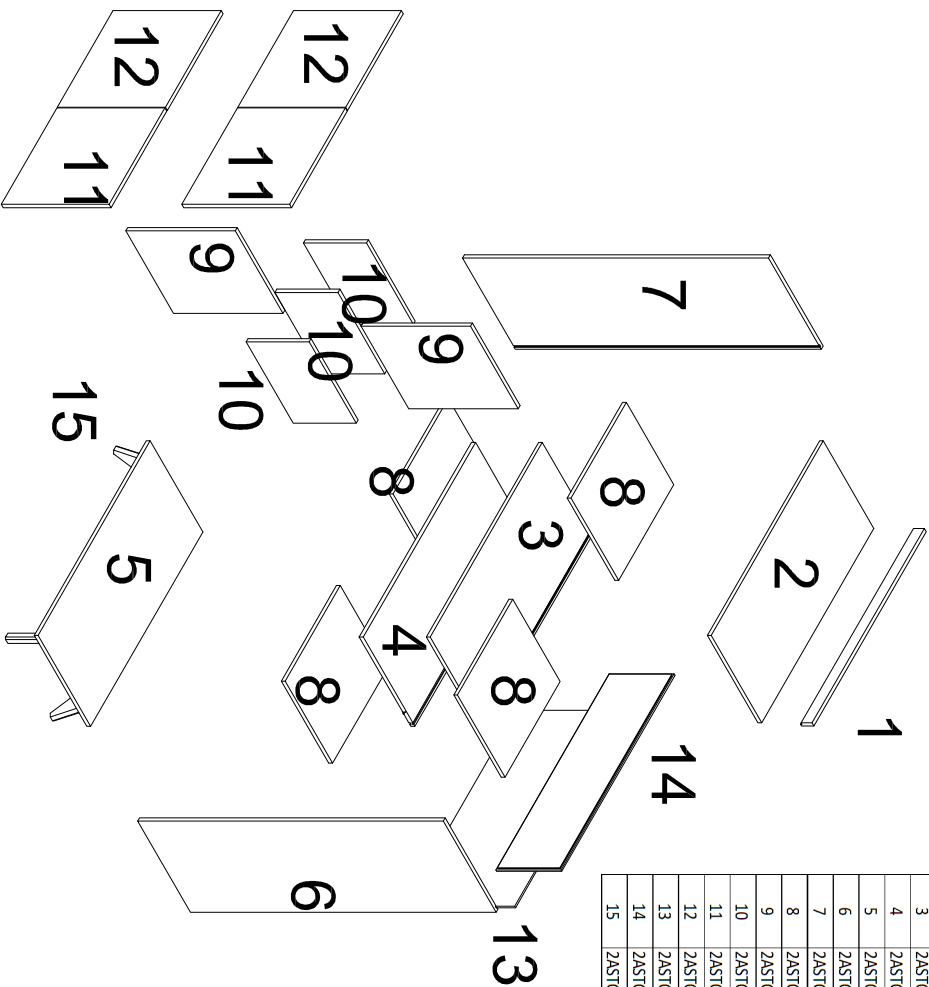

PLEASE RETAIN THE LABEL INFORMATION ON THE PACKAGES. DO NOT START ASSEMBLY IF THERE ARE ANY MISSING ITEMS IN THE PACKAGE.  
THE MANUFACTURER IS NOT RESPONSIBLE FOR ANY DAMAGES THAT MAY BE INCURRED DURING THE ASSEMBLY PROCESS AND LATER ON DUE TO THE MISUSE OF BUYERS.  
KOLU ÜZERİNDEKİ ETİKET BİLGİLERİNİ SAKLAYINIZ KOLU İÇERİSİNDE EKSIK PARÇA VARSA LÜTFEN MONTAJA BAŞLAMAYINIZ.  
MONTAJ ESNASINDA VE DAHA SONRA KULLANICI HATLA ARINDAN DOĞRUK HİŞARULRDA ÜRETİCİ FİRMA SORUMLU DEĞİLDİR.



444 6 999

Toll-free information line only  
for domestic calls-Türkiye

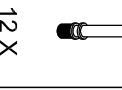
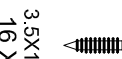
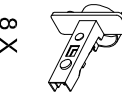
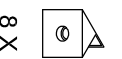
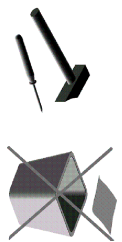

GM-FO-054/REV01

PAGE : 1/5

