

1

3,5 16 (3516) vidaları sıkarak montajını yapınız
Fix the 3,5x16 (3516) screws

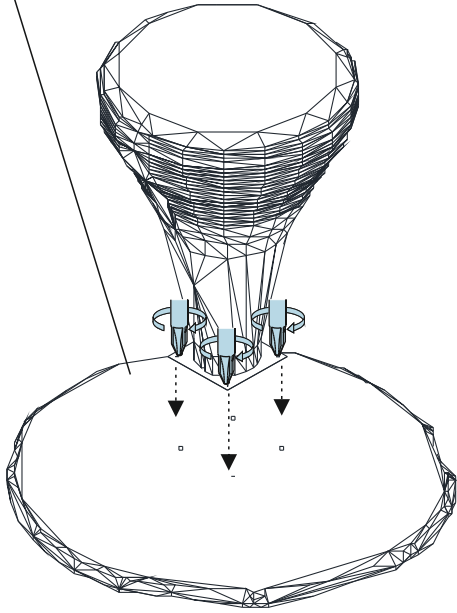

3,5 30 (3530) vidaları sıkarak montajını yapınız
Fix the 3,5x30 (3530) screws

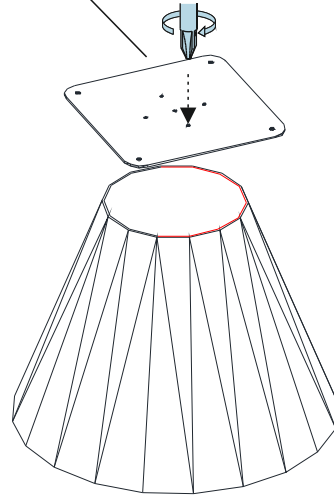

2

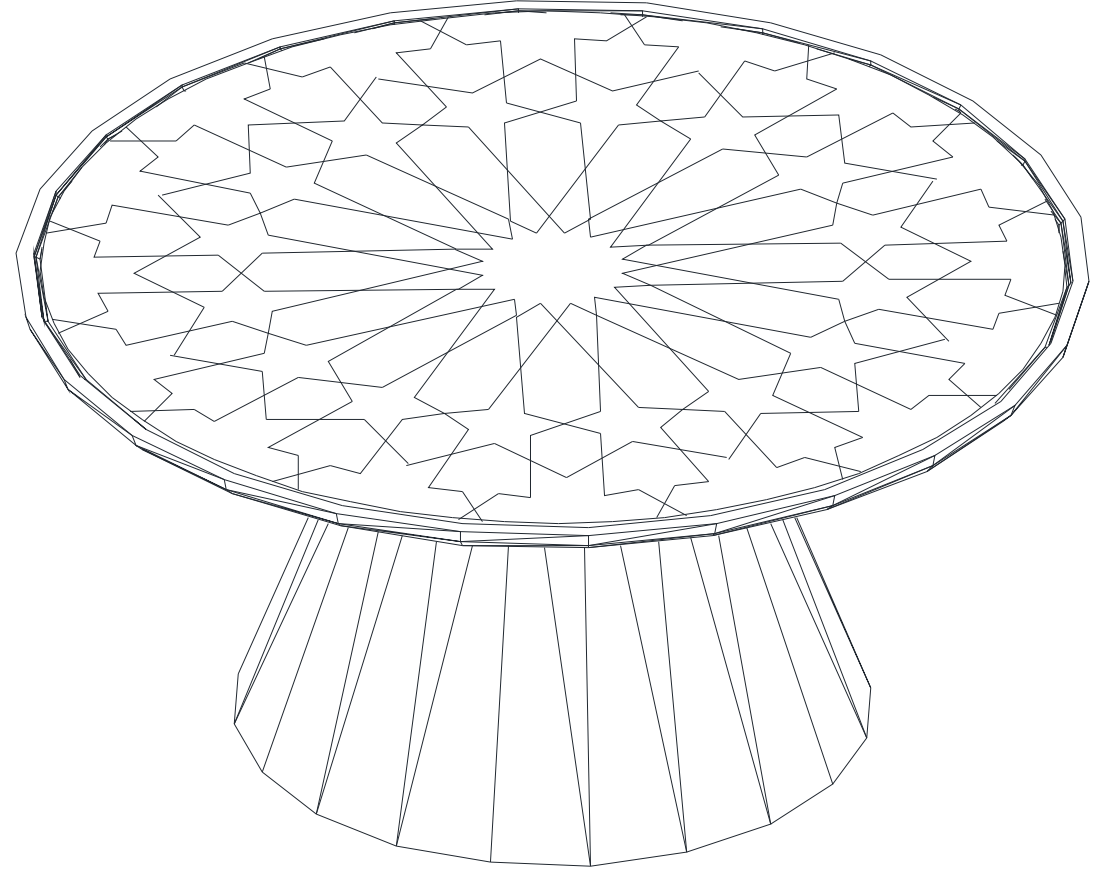

MONTAJ BİTTİKTEN SONRA SEHPAYI ÇEVİRİRKEN AYAKLARIN YERE EŞ ZAMANLI
TEMAS ETMESİNİ SAĞLAYINIZ

AFTER INSTALLATION, MAKE SURE THE BOTTOM OF THE TABLE TOUCHES
THE GORUND AT THE SAME TIME



VIDA SIKMA YÖNÜ

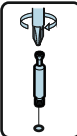

NOT : YAZILARDA PARANTEZ İÇİNDE
BELİRTİLENLER MALZEME KODUDUR
MALZEME İSTERKEN KOD İLE
İSTENİLİRSE GERİ DÖNÜŞÜ
O KADAR HIZLI OLACAKTIR.

NOTE: THE CODES WRITTEN
IN THE BRACKETS ARE
SYMBOLISING THE
MATERIAL CODES